

ALUCOBOND  
**Interiors**



**Houston Center Lobby Renovation**  
ALUCOBOND PLUS: HC Champagne Gold,  
HC Glacier, Gallery White  
Architect: Gensler  
© Peter Molick

# Modern modality, Seamless transition, Dynamic colors, **ALUCOBOND Interiors.**

ALUCOBOND® has been a trusted exterior architectural cladding for over 50 years, now is the time to transition your thinking to Interiors. Learn how ALUCOBOND has been *giving shape to great ideas* by helping our customers lead the world in design innovation, and continually adapting to the needs of the growing architectural community.

[COLOR BROWSER](#)

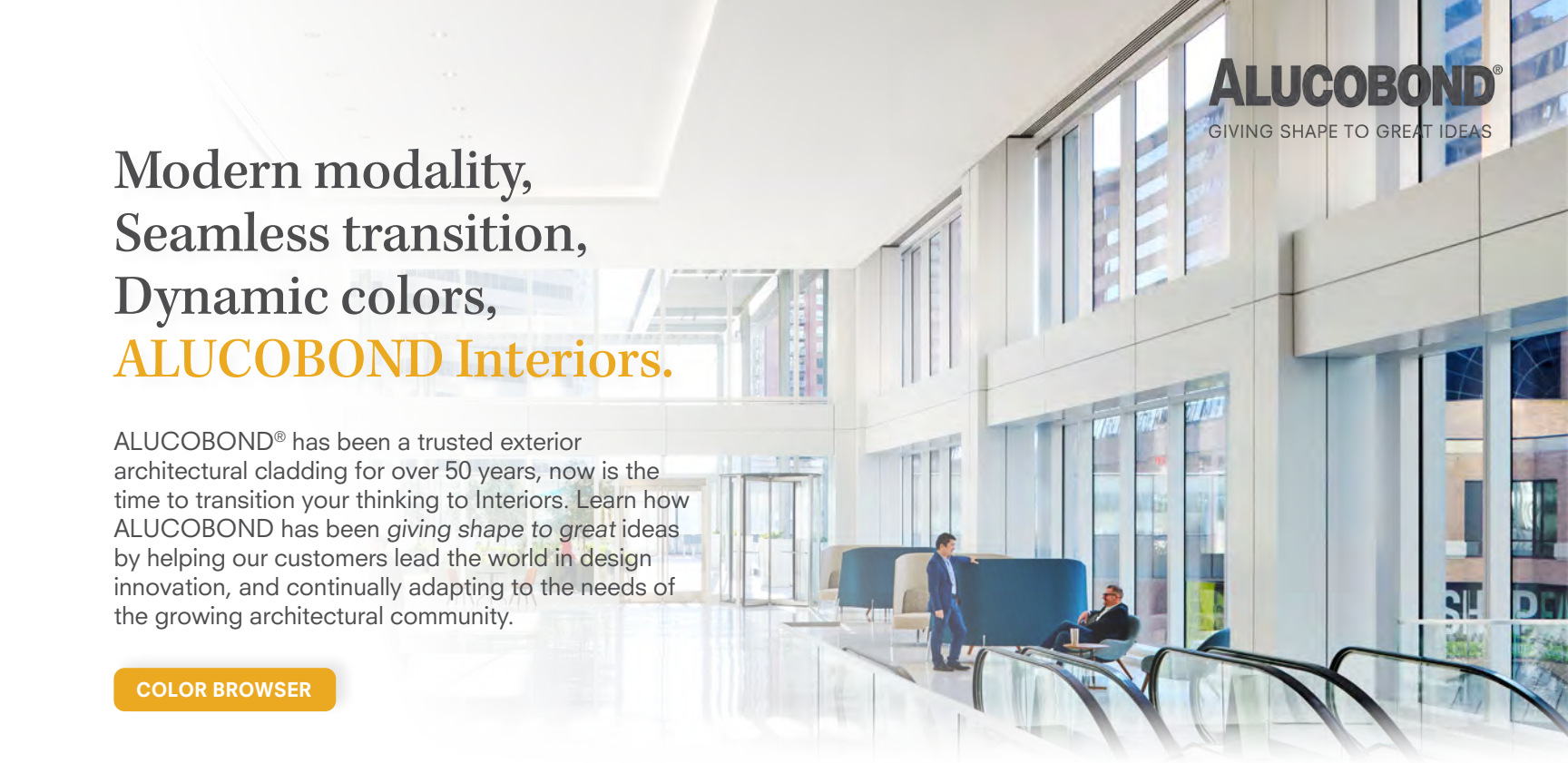

## Aesthetics

- Seamless transition from exterior facade to interior design
- Dynamic color palette of 89 stock colors & finishes
- Ability to create unique customizable shapes
- Biophilic hues effortlessly complement surroundings
- Large flat panels inspire clean design
- Custom color capabilities
- Create striking modern designs

[Houston Center - Interior Lobby Renovation](#) (left) © Peter Molick  
Arkansas Children's Hospital Pine Bluff Clinic exterior & interior cladding (bottom) © Tim Hursley

## Technical

- Easy to fabricate & install
- Emits zero VOC's
- 100% Recyclable
- Durable
- Lightweight
- UV Resistant
- Perforation capabilities
- Made in the USA

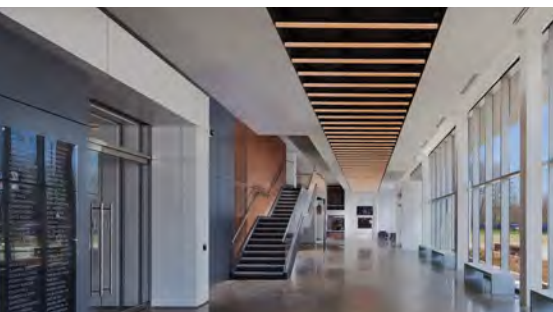

## Applications

- Wall cladding
- Feature wall
- Beam wrap
- Baffles
- Stairway
- Architectural ceiling
- Column cover
- Entry Way
- Mechanical covering

[IBEW Local 134 Headquarters](#) (above) © Paul Schlismann courtesy of Wight & Co. | [University of Texas - Austin](#) (above)



ALUCOBOND® is a registered trademark of 3A Composites USA Inc.  
© 2022 3A Composites USA. All Rights Reserved.

## Fabrication Systems

The same exterior hanging systems can be used on the interior for ALUCOBOND PLUS installation. However, the lack of windloads and exterior forces allows for simpler hanging systems with less reinforcement.

### Face Fastened

A Face Fastened system eliminates the need for routing panels, and can provide a clean aesthetic when using fasteners that are painted to match ALUCOBOND panels.

[Select image to view full detail](#)

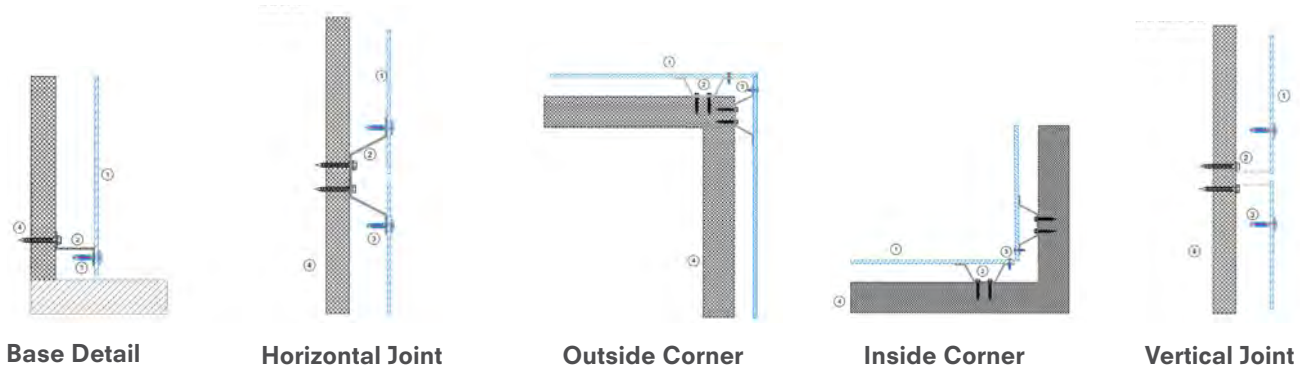

Base Detail

Horizontal Joint

Outside Corner

Inside Corner

Vertical Joint

### Edge Capture

Edge Capture systems allow for the least amount of preparation of the ALUCOBOND panels, and can be a great option for feature walls or decoration.

[Select image to view full detail](#)

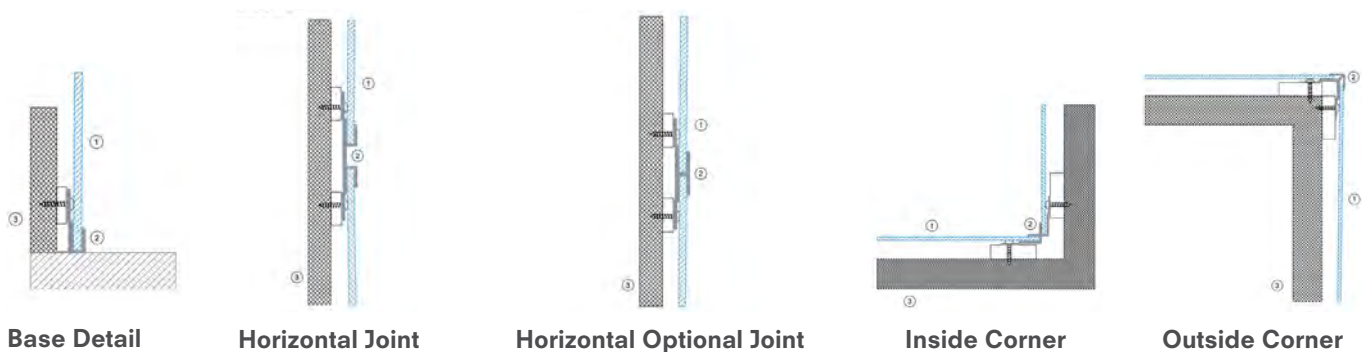

Base Detail

Horizontal Joint

Horizontal Optional Joint

Inside Corner

Outside Corner

### Tape

Taped systems have long been used in both the exterior and interior markets. Tape systems involve shop application of hanging extrusions which are then hung onto pre-placed clips or rails. Manufacturers such as 3M and Tesa, have numerous products that have been successfully used in hanging ACM all over the world.

[Select image to view full detail](#)

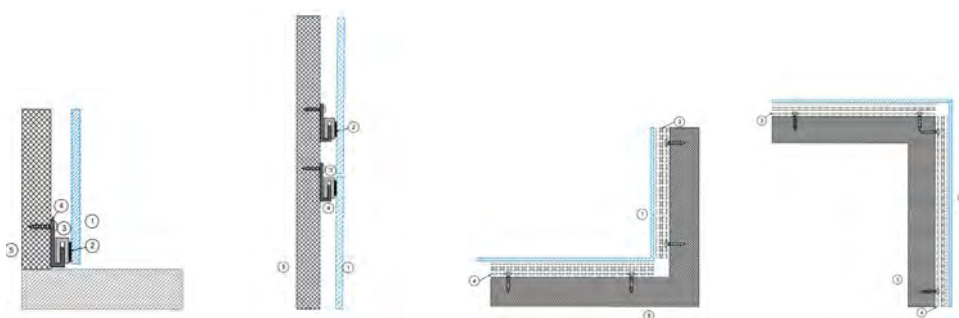

Base Detail

Horizontal Joint

Inside Corner

Outside Corner